

Addendum 01

Project	Bucks County Free Library Bensalem Ceiling and Lighting
RHJ Project ID	2025-0889
Addendum No.	01
Submitted By	Bucks County Free Library
Issued	2026-03-19

TO ALL BIDDERS:

This addendum shall modify the Contract Drawings and Specifications as herein noted and delineated. The Contractor shall so note the changes and modify the bid proposal accordingly. This addendum shall, in total, be added to the Contract Documents for the above referenced project.

Item #1 RFI Question:

- 1. Please verify Ceiling Tile Specification.***

RFI Answer:

Armstrong Ceiling Solutions, Ultima Square Lay-In White, 24"x48"

Item #2 RFI Question:

- 1. Please verify Switch Location***

RFI Answer:

See attached drawing SK.1.

Item #3 RFI Question:

- 1. Please verify requirements for Temporary Lighting.***

RFI Answer:

Temporary lighting in sections to be provided by G.C. and determined by BCFL.

Item #4 RFI Question:

- 1. Please verify scope of work in Existing Vestibule.***

RFI Answer:

G.C. to remove existing lighting fixtures and provide new as shown on drawing A.1. G.C. to patch existing ceiling as required.

Item #5 RFI Question:

- 1. Are we touching fire alarms, cameras, speakers?***

RFI Answer:

No. If conflict occurs in field, coordinate with BCFL.

York, PA
1601 2nd Avenue
York, PA 17403
(717) 845-3644

Philadelphia, PA
123 S. Broad Street, Suite 1140
Philadelphia, PA 19109
(215) 279-5845

Paoli, PA (HQ)
10 Leopard Road, Floor 2
Paoli, PA 19301
(610) 337-4555

Mount Laurel, NJ
303 Fellowship Road, Suite 212
Mount Laurel, NJ 08054
(856) 252-0040

Wilmington, DE
3316 S. Rockfield Drive
Wilmington, DE 19810
(302) 482-2269

Item #6 RFI Question:

1. Does this project have Buy American requirements?

RFI Answer:

No.

Item #7 RFI Question:

1. Does this project have RACP requirements?

RFI Answer:

No.

Item #8 RFI Question:

1. Is this a Tax Exempt project? If so, please provide current tax certificates stating type?

RFI Answer:

Refer to Specifications.

Item #9 RFI Question:

1. Does this project require certified payroll?

RFI Answer:

Yes, certified payroll is to be submitted with pay application.

Item #10 RFI Question:

1. Does this project require any work outside the normal working hours from 7-3:30?

RFI Answer:

No.

Item #11 RFI Question:

1. How long are the warranties?

RFI Answer:

Refer to Specifications.

Item #12 RFI Question:

1. Are there liquidated damages?

RFI Answer:

Refer to Specifications.

Item #13 RFI Question:

1. Does this job require scanning for penetrations?

RFI Answer:

No.

York, PA
1601 2nd Avenue
York, PA 17403
(717) 845-3644

Philadelphia, PA
123 S. Broad Street, Suite 1140
Philadelphia, PA 19109
(215) 279-5845

Paoli, PA (HQ)
10 Leopard Road, Floor 2
Paoli, PA 19301
(610) 337-4555

Mount Laurel, NJ
303 Fellowship Road, Suite 212
Mount Laurel, NJ 08054
(856) 252-0040

Wilmington, DE
3316 S. Rockfield Drive
Wilmington, DE 19810
(302) 482-2269

Item #14 RFI Question:

- 1. Does the Lighting Package require remote drivers? If yes, Please identify which fixture types. Please provide engineered details and locations.**

RFI Answer:

Not Required.

Item #15 RFI Question:

- 1. Please provide the building fire alarm vendor contact information.**

RFI Answer:

County of Bucks Fire Marshal's Office (215-340-8730)

Item #16 RFI Question:

- 1. Are ARC Flash short circuit ground fault coordination studies required?**

RFI Answer:

Not Required.

Item #17 RFI Question:

- 1. Are device rings and strings an acceptable method for Tele/Data rough in?**

RFI Answer:

N/A

Item #18 RFI Question:

- 1. Can demo be completed in first Phase of project?**

RFI Answer:

No.

York, PA
1601 2nd Avenue
York, PA 17403
(717) 845-3644

Philadelphia, PA
123 S. Broad Street, Suite 1140
Philadelphia, PA 19109
(215) 279-5845

Paoli, PA (HQ)
10 Leopard Road, Floor 2
Paoli, PA 19301
(610) 337-4555

Mount Laurel, NJ
303 Fellowship Road, Suite 212
Mount Laurel, NJ 08054
(856) 252-0040

Wilmington, DE
3316 S. Rockfield Drive
Wilmington, DE 19810
(302) 482-2269

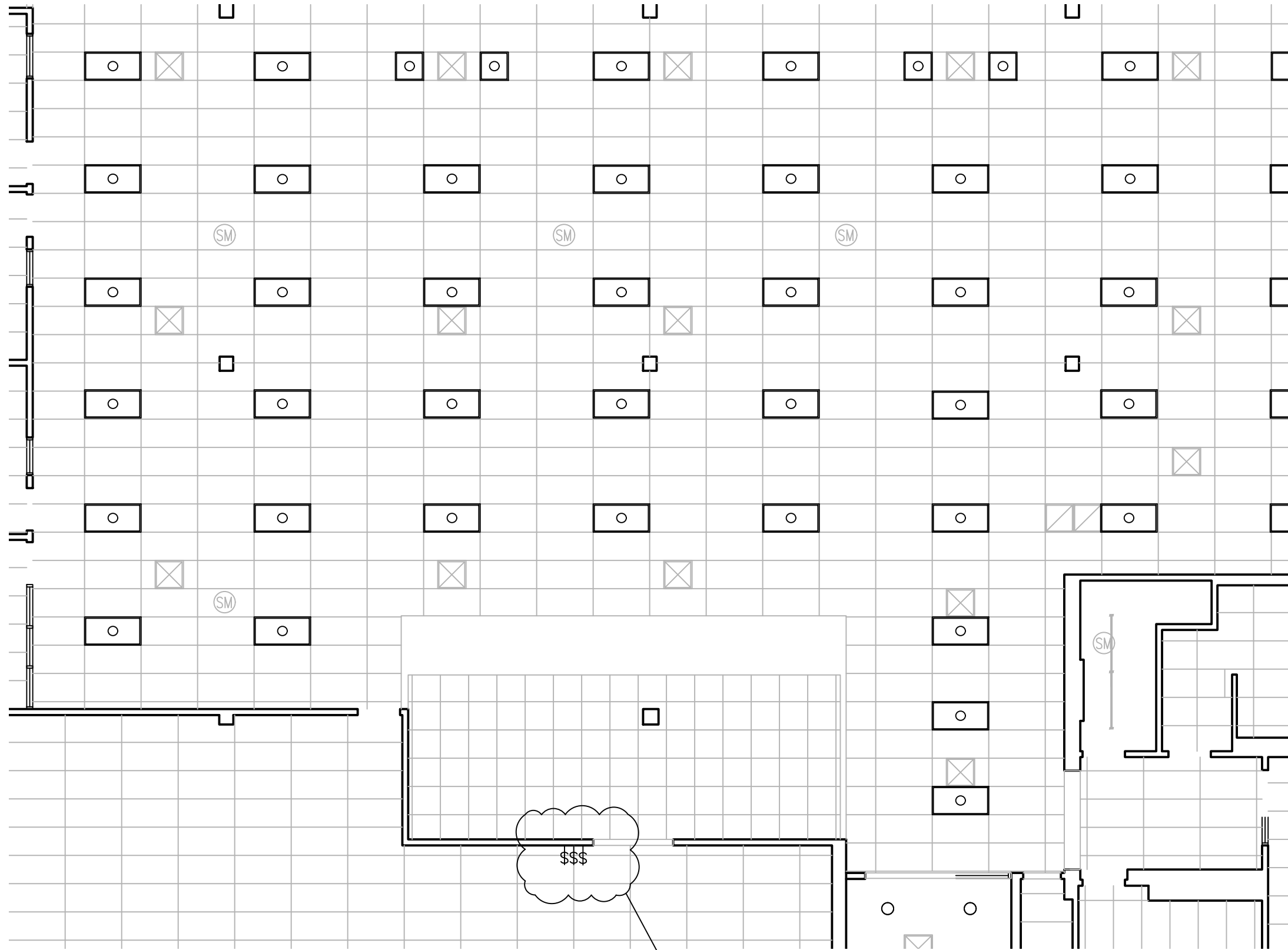

ADDENDUM #1

SCALE: 1/8" = 1'-0"



PROPOSED IMPROVEMENTS FOR:
BCFL BENSLEM BRANCH
 3700 HULMEVILLE RD.
 BENSLEM, PA 19020

RHJ ASSOCIATES, PC
 ARCHITECTS · PLANNERS · DESIGNERS

PAOLI, PA 610.337.4555	MOUNT LAUREL, NJ 856.252.0040	PHILADELPHIA, PA 215.279.5845	WILMINGTON, DE 302.482.2269	YORK, PA 717.845.3644
www.rhjassoc.com				

DATE 03/19/26
 PROJECT NO. 2025-0889

Y:\BCFL_Benslem Branch_Lighting_Upgrade_2025-0889\Drawings\CDA\BCFL_Benslem Branch_Lighting_Upgrade_2025-0889.dwg